

SoundOff Signal

3900 Central Parkway
Hudsonville, MI 49426
toll free 800.338.7337
office 616.896.7100
techsupport@soundoffsignal.com
www.soundoffsignal.com



by SoundOff Signal

XP 63 LED LIGHT EL6GD(x)



1/4" Screws and Lock Washers
(Customer supplied)

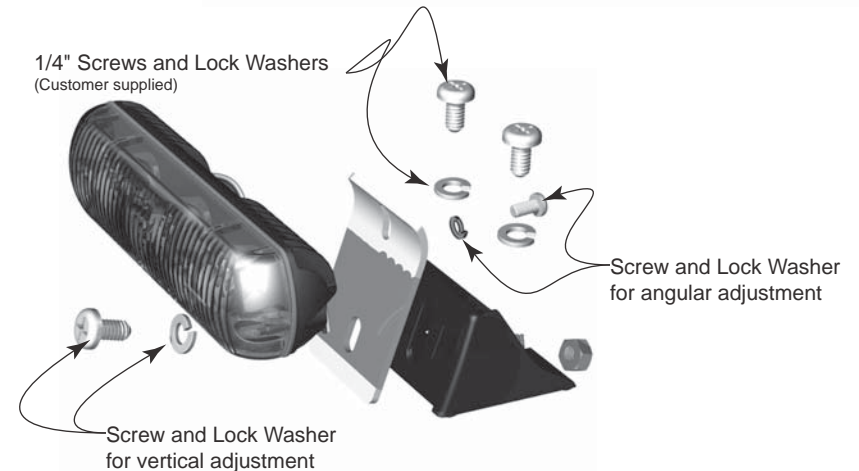

WARNING: Warning devices are strictly regulated and governed by Federal, State and Municipal ordinances. These devices shall be used ONLY on approved vehicles. It is the sole responsibility of the user of these devices to ensure compliance.

BRACKET MOUNTING

IMPORTANT: DO NOT over tighten mounting screws or nuts. This could cause permanent damage to the bracket or case.

NOTE: The **ECONOMY DECK / GRILL LIGHT** is shipped preassembled. Some disassembly is required to properly mount and align light.

1. Locate flat or slightly arched mounting location for **ECONOMY DECK / GRILL LIGHT** Bracket.
2. When position of bracket is determined mark location of oblong slots assuring that light will be perpendicular to long axis of vehicle and drill pilot holes. If wires are to be routed to interior of vehicle a hole should be made between the pilot holes. If the connection is to be made inside the vehicle this can be a small hole but if the cable is to pass through the surface it must be large enough to accommodate the connector.
3. Place bracket over pre-drilled pilot holes and secure to vehicle using 2-1/4" customer supplied screws and lock washer (preferably stainless steel). **DO NOT OVER TIGHTEN SCREWS.**
4. Make cable connections as follows: Red-power, Black-ground. White is for ID and pattern selection and will be taped after selection is made. If the final location of the cable will be inaccessible, ID and pattern selection must be made before final installation. Loose wires from the light should be wrapped under the strain relief in the base.
5. Light is adjusted by loosening the vertical and angular adjustment screws and positioning the light for optimum performance. Make certain that light is positioned horizontally and at the desired height.

OPERATING INSTRUCTIONS

The **ECONOMY DECK / GRILL LIGHT** comes equipped with its own selectable 16 pattern flasher and pattern memory. When desired pattern is selected, it will automatically be stored in the unit's memory and will come up every time the light is turned on.

1. Connect the unit's **BLACK** wire to a good, convenient ground.
2. Connect the unit's **RED** wire to one side of a user supplied on/off switch. Connect the other side of the switch, through a 7.5Amp fuse, to a source of +12Vdc.

PATTERN SELECTION

1. Turn unit ON.
2. Touching and removing the **WHITE** wire to ground will advance the **ECONOMY DECK / GRILL LIGHT** to the next flash pattern. See flash pattern table. Continuing to touch and remove the **WHITE** wire to ground will allow you to scroll through the pattern list. After pattern #16 is reached the list will start over again at pattern #1.

NOTE: The unit is equipped with flash pattern memory. Once you have selected a pattern the unit will always activate to that pattern every time the unit is turned on. Tape up and secure **WHITE** wire so that it will not accidentally change your selected pattern.

NOTE: The light **CANNOT** be serviced in the field. Any attempt to gain access to the unit will most likely cause permanent damage and void its warranty.

WIRE HOOK-UP TABLE

Wire Color	Connect to:
Red	+9-16Vdc
Black	Ground (-)
White	ID/Pattern Select



3900 Central Parkway
 Hudsonville, MI 49426
 toll free 800.338.7337
 office 616.896.7100
 techsupport@soundoffsignal.com
 www.soundoffsignal.com



by SoundOff Signal

XP 63 LED LIGHT EL6GD(x)

⚠ WARNING

This product contains high intensity LED devices. To prevent eye damage, **DO NOT** stare into light beam at close range.

Predator Sync Configuration Instructions

1. Set ID#
 - a. Identify which pattern and sequence you want and look up ID#s on table.
 - b. Connections
 - i. RED: +12Vdc
 - ii. WHT: +12Vdc (Note: you will need to disconnect after power is applied)
 - iii. BLK: Ground
 - c. Apply power to unit
 - d. Without disconnecting power from unit, disconnect WHT wire
 - e. Momentarily connect WHT to Ground to change ID #
 - i. Identify ID# by number of sequential flashes
 - ii. Possible ID#s: 1 – 4
 - f. Disconnect power from unit to get out of ID mode.
2. Set Pattern
 - a. Reapply power to units.
 - b. Once all Light Head ID#s are configured, make sure all lights are flashing the same pattern
 - c. Connect corresponding colored wires of all units together: RED to RED, etc.
 - d. Change Pattern
 - i. Momentarily connect WHT wires to Ground
 - ii. Observe pattern change on all lights connected
 - e. Insulate all wires by taping with electrical tape
3. Connect Master Switch for Application
 - a. **IMPORTANT!** Ensure WHT Pattern/Sync Wires are tied together

		Light Head ID# Table								
		Alternating (ID#s Different for Each Light Head)		Simultaneous (ID#s Same for Each Light Head)		X-Pattern (Available for patterns 15 and 16 Only)				
		Light HD1	Light HD2	Light HD1	Light HD2	Light HD1	Light HD2	Light HD3	Light HD4	Light HD4

Pattern #	Pattern Name	Sequence	Light HD1	Light HD2	Light HD1	Light HD2	Light HD1	Light HD2	Light HD3	Light HD4
1	Quint	ALT	ID# 1	ID# 3	ID# 1	ID# 1	-	-	-	-
2	Warp	ALT	ID# 1	ID# 3	ID# 1	ID# 1	-	-	-	-
3	Inter-Cycle Flash	ALT	ID# 1	ID# 3	NA	NA	-	-	-	-
4	Double	ALT	ID# 1	ID# 3	ID# 1	ID# 1	-	-	-	-
5	Quad Flash	ALT	ID# 1	ID# 3	ID# 1	ID# 1	-	-	-	-
6	3 FPS	ALT	ID# 1	ID# 3	ID# 1	ID# 1	-	-	-	-
7	3 FPS	SIM	ID# 1	ID# 3	ID# 1	ID# 1	-	-	-	-
8	Q-Switch	Variable	ID# 1	ID# 3	NA	NA	-	-	-	-
9	Warp, Steady Burn	Steady Burn	ID# 1	ID# 3	NA	NA	-	-	-	-
10	Quad, Steady Burn	Steady Burn	ID# 1	ID# 3	NA	NA	-	-	-	-
11	E-Pattern Single Flash	ALT	ID# 1	ID# 3	ID# 1	ID# 1	-	-	-	-
12	E-Pattern Double Flash	ALT	ID# 1	ID# 3	ID# 1	ID# 1	-	-	-	-
13	E-Pattern Single Flash	SIM	ID# 1	ID# 3	ID# 1	ID# 1	-	-	-	-
14	E-Pattern Double Flash	SIM	ID# 1	ID# 3	ID# 1	ID# 1	-	-	-	-
15	X-Warp	X	NA	NA	NA	NA	ID# 1	ID# 2	ID# 3	ID# 4
16	X-Double	X	NA	NA	NA	NA	ID# 1	ID# 2	ID# 3	ID# 4

Steady Burn on ID# 1 and 2

ALT: Alternating
 SIM: Simultaneous
 X: X-Pattern

X-Pattern Sequence

ID#1 > ID#4 > ID#2 > ID#3

X-Pattern Light Head Placement

ID#4	ID#2
ID#3	ID#1

1 LIGHT

Single Light Operation: Follow the ID Selection steps and set the LED3 to ID#1 if it is not already. NOTE: Steady Burn is produced for patterns 9 & 10 in Single Operation.

2 LIGHTS

ALTERNATING: To obtain Alternating patterns, follow the ID SELECTION steps and set one LED3 to ID#1 and the other to ID#3. Then proceed to the PATTERN SELECTION steps.

SIMULTANEOUS: To obtain Simultaneous patterns, follow the ID SELECTION steps and set both LED3 lights to ID#1. Then proceed to PATTERN SELECTION steps.

4 LIGHTS

X-Pattern: To obtain X-patterns, follow the ID SELECTION steps and set one of the four LED3 lights to ID#1, one to ID#2, one to ID#3, and one to ID#4. Then proceed to PATTERN SELECTION steps. NOTE: Be sure to mount each LED3 in the correct placement based on ID#.

WARRANTY

SoundOff Signal warrants the EL6GD(x) Economy Deck/Grill Light for five (5) years from the date of purchase to the original purchaser against any manufacturing defects or workmanship. This warranty is a 100% replacement value warranty. It applies only to units installed according to manufacturer's installation instructions and operated within the units specifications. Warranty is void if the unit was installed incorrectly or maliciously damaged. All warranty claims must be accompanied by a dated proof of purchase.

SoundOff Signal retains the right to be the sole mediator of what constitutes defects in performance or manufacturing.